

# Spokane Register of Historic Places Nomination

Spokane City-County Historic Preservation Office, City Hall, Third Floor  
808 Spokane Falls Boulevard, Spokane, Washington 99201-3337

## 1. Name of Property

Historic Name **SHEEHY-KELLEHER HOUSE**  
And/Or Common Name

## 2. Location

Street & Number 429 E. Mission Avenue  
City, State, Zip Code Spokane, Washington 99202  
Parcel Number 35083.4607

## 3. Classification

Category of Property	Ownership of Property	Status of Property	Present Use of Property	
<input checked="" type="checkbox"/> building	<input checked="" type="checkbox"/> public	<input checked="" type="checkbox"/> occupied	<input type="checkbox"/> agricultural	<input type="checkbox"/> museum
<input type="checkbox"/> site	<input type="checkbox"/> private	<input type="checkbox"/> work in progress	<input type="checkbox"/> commercial	<input type="checkbox"/> park
<input type="checkbox"/> structure	<input type="checkbox"/> both		<input type="checkbox"/> educational	<input checked="" type="checkbox"/> residential
<input type="checkbox"/> object	<b>Public Acquisition</b>	<b>Accessible</b>	<input type="checkbox"/> entertainment	<input type="checkbox"/> religious
<input type="checkbox"/> district	<input type="checkbox"/> in process	<input type="checkbox"/> yes, restricted	<input type="checkbox"/> government	<input type="checkbox"/> scientific
	<input type="checkbox"/> being considered	<input checked="" type="checkbox"/> yes, unrestricted	<input type="checkbox"/> industrial	<input type="checkbox"/> transportation
		<input type="checkbox"/> no	<input type="checkbox"/> military	<input type="checkbox"/> other

## 4. Owner of Property

Name Ray and Cathy Kelleher  
Street & Number 429 E. Mission Avenue  
City, State, Zip Code Spokane, Washington 99202  
Telephone Number/E-mail (509) 326-9563 /

## 5. Location of Legal Description

Courthouse, Registry of Deeds Spokane County Courthouse  
Street Number 1116 West Broadway  
City, State, Zip Code Spokane, WA 99260  
County Spokane

## 6. Representation in Existing Surveys

Title Logan Neighborhood Survey  
Date 1985 Federal\_\_ State\_\_ County\_\_ Local X  
Depository for Survey Records City-County of Spokane Historic Preservation Office

## 7. Description

### Architectural Classification

(enter categories from instructions)

### Condition

excellent

good

fair

deteriorated

ruins

unexposed

### Check One

unaltered

altered

### Check One

original site

moved & date \_\_\_\_\_

*Narrative description of present and original physical appearance is found on one or more continuation sheets.*

## 8. Spokane Register Criteria and Statement of Significance

**Applicable Spokane Register of Historic Places Criteria--mark "x" in one or more boxes for the criteria qualifying the property for Spokane Register listing:**

A Property is associated with events that have made a significant contribution to the broad patterns of Spokane history.

B Property is associated with the lives of persons significant in our past.

C Property embodies the distinctive characteristics of a type, period, or method of construction, or represents the work of a master, or possesses high artistic values, or represents a significant and distinguishable entity whose components lack individual distinction.

D Property has yielded, or is likely to yield, information important in prehistory history.

*Narrative statement of significance is found on one or more continuation sheets.*

## 9. Major Bibliographical References

*Bibliography is found on one or more continuation sheets.*

## 10. Geographical Data

Acreage of Property

Less than one acre.

Verbal Boundary Description

Heath's 4<sup>th</sup> Addition/Block 46/Lot 7

Verbal Boundary Justification

Nominated property includes entire parcel and urban legal description.

## 11. Form Prepared By

Name and Title

Ray Kelleher

Telephone Number/E-mail

(509) 326-9563/

Street and Number

429 E. Mission Avenue

City, State, Zip Code

Spokane, Washington 99202

Date

May 2007

## 12. Additional Documentation

Map

Photographs and Slide

13. Signature of Owner(s)

Name Raymond L. Keller

Name Catherine Zschaler

14. For Official Use Only

Date Received \_\_\_\_\_ Attest \_\_\_\_\_

Date Heard \_\_\_\_\_ City Clerk \_\_\_\_\_

Commission Decision \_\_\_\_\_ Approved as to Form  
Assistant City Attorney Michael P. Paul

Council/Board Action \_\_\_\_\_

Date \_\_\_\_\_

**We hereby certify that this property has been listed in the Spokane Register of Historic Places.**

\_\_\_\_\_  
DEPUTY MAYOR, City of Spokane  
or

\_\_\_\_\_  
CHAIR, Spokane County Commissioners

\_\_\_\_\_  
CHAIR, Spokane City/County Historic Landmarks Commission

Oliver Pan / Kim

OFFICER, Spokane City/County Historic Preservation Officer  
Spokane City/County Historic Preservation Office  
Third Floor, City Hall, W. 808 Spokane Falls Boulevard, Spokane, WA 99201

**DESCRIPTION OF PROPERTY**

The house that currently stands at East 429 Mission Avenue, a one and a half story Tudor-style Bungalow, was built in 1934 by Otto Bloomquist and Son, a long-time carpenter. The style was common in the late 1920's in Spokane; it looks like several houses constructed by a builder named Pearce on West 20<sup>th</sup> Avenue on the South Hill. However, this house is the only one of this style and architectural design in the Heath and Sinto (Cataldo) additions (which are separated by Mission Avenue).

The building permit for this house was issued August 14, 1934 to John J. Sheehy. Mr. Sheehy and his wife owned the home until 1967, when it was sold to the current owners, Ray and Cathy Kelleher.

The information directly below tells the story of the current house. However, as you read further, you will see that the history of the property may be tracked as far back as 1882, when it was purchased by Sylvester Heath from the Northern Pacific Railway.

**CURRENT APPEARANCE & CONDITION*****Site***

The Sheehy-Kelleher House is located on Lot 7, Block 46 in Heath's 4th Addition and faces south onto East Mission Avenue, a broad boulevard with a center island parkway. The lot measures 50 feet wide and 142 feet deep. The house is framed by a manicured lawn and mature deciduous trees. A concrete walkway approaches the front porch from a concrete sidewalk which runs parallel to Mission Avenue. A driveway is access from North Addison Street. The property is located within the Mission Avenue National Register Historic District, seven residential blocks along the tree-lined avenue that includes the Mission Avenue Parkway and which includes approximately fifty-seven single-family and multi-family homes built from the 1890s through the present.

***House Exterior***

The Sheehy-Kelleher House forms a rectangular footprint which measures approximately 40 feet wide and 50 feet deep. The house is a one and one-half-story building with a cross-gable roof with a dominant front facing gable. The roof is covered in clay tiles and a gabled addition is located on the east elevation. Clad in stretcher bond multi-colored brick veneer, character-defining details include brick diamond patterns in the gable peaks and arched openings in the gabled partial-width front porch. The home additionally features original fixed sash plate glass windows throughout with brick sills. The foundation is made of poured concrete.

*South Elevation*

The front (south) elevation faces south onto East Mission Avenue, at the corner of Mission and North Addison Street. The front elevation features an offset prominent front-facing gabled front porch. With arched openings, the gabled porch features a clay tile roof that matches the rest of the home, and decorative brick work, including a diamond pattern with multi-colored bricks in the gable peak, and brick round arches above the arched openings. An arched solid wood front door is located behind one of the arched openings. While the poured concrete foundation is separated from the first floor by a brick soldier course, the front elevation is further defined by wood fixed sash plate glass windows with brick sills. Visible from the front is a gabled addition to the east which includes a wood sash double-hung window with a multi-pane upper.

*East Elevation*

The east elevation is characterized by dual front facing gables, with a lower gabled addition projecting from the gable end of the home. A brick patterned diamond is featured in the center of the gable peak as well as two double-hung wood sash windows with multi-pane uppers. Both windows are covered by aluminum storms and features brick sills and soldier or flat arches. A back door is located in the lower gabled addition and opens out on the north elevation, or rear of the home, onto a poured concrete and brick patio.

*West Elevation*

The west elevation is dominated by a large brick exterior chimney that tapers towards the top. The chimney features the same diamond motif seen on the other elevations and is flanked by two small double-hung windows. The west elevation is further characterized by paired double-hung windows in the gable peak.

*North Elevation*

The north elevation is the rear of the home and faces a poured concrete and brick patio and a hipped roof two-car garage that is accessed from N. Addison Street. A back door opens onto the patio and feature wrought iron handrails and poured concrete steps.

***Garage***

The two-car garage, with a hipped roof and featuring brick veneer that matches the cladding of the house, was constructed in 1934 as a single-car garage. The garage is located at the rear (north) of the home and is accessed from a poured concrete driveway off N. Addison Street to the east. In 1936 the garage was expanded to incorporate space for a second car.

**ORIGINAL APPEARANCE & SUBSEQUENT MODIFICATIONS**

Building Permit number 43234 was issued August 14, 1934 to J.J. Sheehy—owner of the lot located at E 429 Mission. Mr. Sheehy's home address was listed as 730 E Boone Ave; he was chief clerk with the Union Pacific Railway Company.

The 1903 City Directory shows the builder, Otto Bloomquist and Son, living at 224 Huron; the 1905 directory showed him as residing at 1409 Main Avenue; and the 1934 directory lists the carpenter's business at 1120 S. Walnut Street.

The house, a one and a half story Tudor-style Bungalow, has a foot print of 1,470 square feet. It has a side gable roof, with projecting gable additions on one side and an end-gable roof porch on the front. The house and its non-attached single-car garage are brick veneer.

The front porch and entry has five brick Roman arches and a darker, decorative brick diamond pattern design at each gable point. This style was common in the late 1920's in Spokane; it looks much like several houses constructed by a builder named Pearce on West 20<sup>th</sup> Avenue on the South Hill.

The five rooms on the Main floor consist of a large living room, dining room, kitchen, bathroom and two bedrooms. The flooring was oak, except for the kitchen which was red fir. The house was built with a finished and plastered stairway to the upper half-story (845 square feet) and an unfinished, full basement.

*Additions and changes:*

- October 28, 1936: Permit number 47945  
A brick veneer second garage was constructed and attached to the existing garage by builder R.C. Toepel.
- July 31, 1967: Jane A. Sheehy—individually, and an executrix of the estate of John J. Sheehy, deceased—conveyed to Raymond L. and Catherine G. Kelleher—husband and wife—for the sum of \$19,000, the home and property (Lot 7 in Block 46 of Heath's Addition IV, Locates in Twp 25 Range Sect SW in Spokane County, Washington. Statutory Warranty Deed 309519C [Deed book 890, page 334]).
- December 7, 1967: Electrical Permit number C 9998, Power City Electric  
A 200 amp electrical service was installed, the home was rewired and power was extended to the half-story and garage.
- 1971: The house was re-plumbed and the half-story was finished by the owner. The half-story has two bedrooms, a bath, and five walk-in closets. To match the

- first floor, the walls were finished in plaster and the doors and moldings are identical.
- July 6, 1972: Permit number B 1946  
A wood fence with brick posts was constructed. The posts were made from recycled street bricks that were removed from the Gonzaga University area.
- 1985: The original painted kitchen cabinets were replaced with oak cabinets.
- December 1, 1993: Permit number B9305730:  
Installed gas service. Replaced original oil-fired furnace with gas burning unit.
- June 13, 2005: Permit number B0506646:  
Owner installed an egress window in the basement den (over the years, the owner installed lighting, a ceiling, walls, sheetrock and flooring to gradually finish the basement).
- March 29, 2006: Permit number B0603533:  
Owner installed an egress window in the basement family room.

The interior and exterior of the home have remained essentially the same as when the home was constructed in 1934. Except for the kitchen, the light fixtures are all period-correct.<sup>1</sup>

---

<sup>1</sup> City of Spokane Building Permits and County of Spokane Deed Books, Spokane County Courthouse.

Areas of Significance	Architecture
Period of Significance	1934-1967
Significant Date	1934
Architect	Unknown
Builder	Otto Bloomquist and Son

### **STATEMENT OF SIGNIFICANCE**

Constructed in 1934, the Sheehy-Kelleher House was built during the last phase of single-family construction along East Mission Avenue, between the 200 and 800 block, what is today identified as the Mission Avenue National Historic District. In 1986, the Sheehy-Kelleher House was designated as a contributing historic resource of the Mission Avenue District. The Sheehy-Kelleher House is an excellent example of the Tudor Revival style. The Sheehy-Kelleher House was constructed for John J. Sheehy, chief clerk with the Union Pacific Railway Company, and his wife Jane. Ray and Cathy Kelleher later acquired the property in 1967. During the property's period of significance from 1934 to 1967, the Sheehy-Kelleher House achieved historic significance for its association with the architectural development and settlement of the Logan Neighborhood, specifically along East Mission Avenue, and is additionally architecturally significant as an example of the Tudor Revival style. Historically and architecturally significant, the Sheehy-Kelleher House is nominated for listing on the Spokane Register of Historic Places under Categories C.

### **HISTORICAL CONTEXT**

#### ***Mission Avenue National Register Historic District and the Logan Neighborhood***

The Mission Avenue Historic District is a seven block portion of East Mission Avenue between North Lidgerwood Street and North Hamilton Street in Spokane, Washington. Designated and listed on the National Register of Historic Places in 1986, the Logan Neighborhood, of which Mission Avenue is a part, was developed by Sylvester Heath and Jesuit missionary Father Joseph Cataldo who established Gonzaga University. Heath purchased and platted the property on the north side of East Mission Avenue, while Father Cataldo developed Gonzaga on the south side of the broad boulevard.

#### ***Sylvester Heath and Mission Avenue***

Sylvester Heath was born March 20, 1847, near Noblesville in Hamilton County, Indiana. He came west to Walla Walla in 1878. In 1879 he moved to Spokane Falls, Washington Territory. He first settled on a 360 acre farm, a region where Mica is now situated. Besides farming, he raised Morgan thoroughbreds. One of 15 benefactors, including J.N. Glover and A.M. Cannon, Heath pledged monies to Father Cataldo in October 1881 for construction of a college (Gonzaga).



Heath began his mercantile career in the merchandise store on Cannon and Warner, where the post office was located. After being appointed postmaster, he opened a stationery store in conjunction with the post office. His store, located at 101 W. Riverside Ave., was destroyed by the 1889 fire. He turned over his stationery business to John W. Graham.

On June 11, 1882 he married Ida E. Ellis. Ida Ellis was born in Brownsville, Oregon on June 4, 1863. She came to Spokane Falls in 1877. The Heaths commenced housekeeping in a small house on Riverside and Monroe. After the fire of 1889, they moved to a house on the corner of Mission and Dakota.

In 1882, Sylvester Heath purchased a half-section of land, bounded by Carlisle Street on the north; Mission Avenue on the south; Victoria (Division) Street on the west; and Perry Street on the east. Heath's south property line is adjacent to property purchased by Joseph M. Cataldo, a Jesuit priest. By inference, the property was purchased after February 24, 1882. Schoenburg's "Gonzaga University—Seventy-five Years 1887-1962," relates that on February 24, 1882, Northern Pacific had not received deed from the Government (Reference Township 25 N-Range 43). On April 8, 1882, Father Van Gorp paid Judge Lewis for the half-section.

- Heath's First Addition to Spokane Falls Territory was surveyed and certified by H.M. Maxwell in June 1883; and filed and recorded in the Book of Plats January 12, 1884. It was bordered by Sellwood Street (Lidgerwood) on the west; Dakota Street on the east; Carlisle on the north; and Indiana on the south.
- Heath's Second Addition – May 27, 1884: Indiana on the north; Mission on the south; Victoria (Division) on the west; and Sellwood Street (Lidgerwood) on the east.
- Heath's Third Addition – September 1, 1886. Carlisle on the north; Indiana on the south; Victoria (Division) on the west; and Sellwood Street (Lidgerwood) on the east.
- Heath's Fourth Addition was dedicated to Spokane Falls, Washington Territory on December 15, 1887 and recorded on January 9, 1888. Indiana on the north; Mission on the south; Sellwood Street (Lidgerwood) on the west; and Dakota on the east, excluding the plot from Pacific (Standard) to Dakota and Mission to Nora.

On this plat Sylvester Heath built his home in 1898; the address was 613 E. Mission Ave.

- Heath's Fifth Addition, August 25, 1889. Dakota on the west; Harrison (Perry) on the east; Carlisle on the north; Mission on the south.

On January 7, 1913, Mr. and Mrs. Sylvester Heath donated two lots on the corner of Mission and Standard, valued at \$7,000, to the city for a library. A contract was awarded to John T. Hutter with a bid of \$27,584 (*Spokesman Review*, July 2, 1913). The corner stone for the Heath's Library was laid November 15, 1913 by C.O. Conner, chair of the Library Board. Placed in the cornerstone was a copper box containing the deed from Mr. and Mrs. Heath (*Spokesman Review*, November 16, 1913).

On March 6, 1917, Mrs. Ida E. Heath died while in California.

On August 26, 1918 Sylvester Heath married Mrs. D.C. Newman (Mary Vye Hickey), widow of a pioneer physician. Mary Van Hickey was born in Quincy, Indiana in 1859 and was raised in Muncie, Indiana. She came to Spokane Falls in 1889 with her husband Dr. D.C. Newman.

Sylvester Heath died October 10, 1925. He was recognized as one of Spokane's pioneer capitalists.

After Sylvester Heath's death, Mary carried on the business affairs, maintaining a downtown office for many years. She died on May 6, 1937.

### ***Sheehy-Kelleher House***

Part of the last period of construction along East Mission after 1910, the Sheehy-Kelleher house was constructed for John J. and Jane Sheehy in 1934. The property was originally owned by Sylvester S. Heath who had purchased and platted the north side of East Mission Avenue around 1884.

### ***Previous Owners:***

- First deed - March 10, 1894: Sylvester Heath and Ida A. Heath sold Lot 7 in Block 46, Heath's IV Addition, in Spokane TWP 25; Range Section SW; Tax/Parcel NO 35083-4607: E. 429 Mission, to Ingeborg Chilberg for \$800. (Deed Book 58, Page 552)
- 1895: Water Permit: NO: 767 - Wm. Brown & Associates
- Permit records: First Floor - 4; Second Floor - 4; Baths - 1; Stable

- 1895 to October 26, 1897: Ingeborg Chilberg and her husband Whilberg Chilberg, a carver for Washington Mill Co., lived at 429 E. Mission
- October 26, 1897: Ingeborg Chilberg and Whilberg Chilberg sold the property to George T. Brown and Alberta Brown, husband and wife. George Brown was a
- bookkeeper at Spokane Drug Company. (Warranty Deed 18156) [Deed Book 84, Page 525]
- January 27, 1899: George T. Brown and Alberta Brown sold the property to James C. Towhy, for \$4,500. (Warranty Deed 28836) [Deed Book 97, Page 12] James C. Towhy came to Spokane Falls from Minnesota with his brothers Denis D. and John W. The Towhy Brothers were railroad contractors.
- November 30, 1907; Electrical Permit NO: 183; Contractor – Spokane Electric
- 1909 - Sewer Permit: NO: 3511 - Peterson
- May 8, 1909: Edmund Paul Towhy, executor of the deceased James C. Towhy sold the property to Charles E. Watson, for \$2,150. (Deed 2.64545) [Deed Book 244, Page 546]
- December 19, 1910: Charles E. Watson and Lilly N. Watson sold the property to Henry C. Lewis for \$10,000. (Warranty Deed 30-7213) [Deeds Book 354, Page 186]
- January 21, 1911; Water Meter – Permit NO: 2234 - H.L. Lewis
- December 14, 1914: Henry C. Lewis and Ada L. Lewis, husband and wife, were in default and the property went into foreclosure. John E. Koppe and Carrie Koppe, husband and wife, purchased the property from De Tweede Northwestern and Pacific Hypetheek Bank, a corporation formed under the laws of the Kingdom of the Netherlands, for \$3,137.40. (Warranty Deed 439111) [Deed Book 243, Page 266]
- May 15, 1922: Jennie E. Sherman, wife of Gardner E. Sherman, as her sole, separate and individual property, conveyed the property to Emma F. Stone, wife of Wesley C. Stone, for \$1. (Quit Claim Deed 694315) [Deed Book 398, Page 13]
- June 24, 1924 (Quit Claim Deed 760297): Emma F. Stone, wife of Wesley C. Stone, to Jennie E. Sherman, wife of Gardner E. Sherman, for \$1. Gardner E.

Sherman was a salesman for T&G (Tull & Gibbs, a Spokane prestigious furniture store). [Deed Record 394, Page 558]

- The Sanborn Insurance Maps from 1910 to 1926 show a two-story wooden structure, single-family house with a wraparound porch, a building on the northeast corner of the lot and a small building on the northwest corner of the lot.
- February 19, 1934: Emma F. Stone and Wesley C. Stone, husband and wife, conveyed to De Tweede Northwestern and Pacific Hypotheek Bank all interest of the property, for \$1. (Quit Claim Deed 159755A Filed Feb. 23, 1934) [Deed Book 459, Page 284]
- February 16, 1934: De Tweed Northwestern and Pacific Hypotheek Bank transferred the property to John J. Sheehy and Jane A. Sheehy, his wife, for the sum of \$10,000 (Deed 159935A filed Feb. 26, 1934) [Deed Book 459, Page 299]. Sheehy was chief clerk with the Union Pacific Railway Company.<sup>2</sup>

*Current Owners: The Kelleher Family*

Raymond L. (Ray) Kelleher came to Spokane in August 1954 with a Marine Corps detachment assigned to the Naval Air Station (NAS), Spokane at Geiger Field. He married Catherine (Cathy) Baldus on August 18, 1956.

Ray graduated from Gonzaga University and taught grade school for one year. He returned to Gonzaga and continued classes in Chemistry. During this time, he worked weekend nights as an officer on the City of Cheney Police department.

He was asked to join two GU professors in research and development of air pollution control and monitoring equipment. He then formed a company to manufacture mobile monitoring labs, including air, water and noise pollution, and provided professional air pollution monitoring and consulting services.

Kelleher built and operated Spokane's first Vehicle Emission Testing Station, located at 819 N. Hamilton Street, in 1986, and built and operated a facility to recycle electrical transformers and equipment for utility companies. After selling that business and retiring, he went back to teaching—substituting in math and science for Spokane School District #81. He also serves on the Advisory Board for the Spokane County Air Pollution Control Authority (SCAPCA).

---

<sup>2</sup> County of Spokane Deed Books, Spokane County Courthouse; Apparently, De Tweed Northwestern and Pacific Hypotheek Bank, located at 120 N. Wall Street, held the mortgage on the property from 1914 to 1934. There are no deeds of record showing the transfer of property from John E. Koppe and his wife, Carrie to Jennie H. Sherman.

Cathy was born in Genesee, Idaho. She graduated from Holy Names College with a degree in Education and later received her Masters in Education from Gonzaga University. She taught in District 81 for 40 years.

Ray and Cathy have four children. All attended St. Aloysius Grade School and Gonzaga Preparatory High School.

- Patrick (born February 14, 1958) received a degree in Mechanical Engineering at Gonzaga University and later his Masters in Aeronautical Engineering from the University of Tennessee while serving as a Marine Corps test pilot at NAS, Patuxent River, Maryland. He retired after 20 years in the Marines and currently works for a defense contractor.
- Michael (September 1, 1961) received a BA in Radio-Television Production and Management from Eastern Washington University. He worked with his father for several years in the family's businesses; as well as part-time in radio and television. He currently works in Public Relations at Sacred Heart Medical Center.
- Thomas (April 15, 1966) received a BA in Marketing at Washington State University. He did marketing work for software firms in Seattle before traveling to London, England, where he worked for a large marketing firm. He currently is a senior manager for a marketing and branding firm in San Francisco, California.
- Anne (May 26, 1970) received her Bachelors and Masters in Criminal Justice from Washington State University. She taught Criminal Justice for the University of Idaho (Moscow, ID), and is a commissioned law enforcement officer.

## ARCHITECTURAL SIGNIFICANCE

### *Category C*

The Sheehy-Kelleher House is a good example of the Tudor Revival style. According to authors McAlester and McAlester, the Tudor style

is loosely based on a variety of early English building traditions ranging from simple folk houses to Late Medieval palaces. Most houses in this style emphasize high-pitched, gabled roofs and elaborated chimneys of Medieval origin, but decorative detailing may draw from Renaissance or even the modern Craftsman traditions.<sup>3</sup>

---

<sup>3</sup> McAlester, Lee and Virginia McAlester. *A Field Guide to American Houses*. New York: Knopf, 1989, p. 356.

The Tudor style was popular between 1890 and 1940. Derived from English Renaissance buildings of the 16<sup>th</sup> and 17<sup>th</sup> centuries, the Tudor Revival style was often typical of “rambling, asymmetrically massed mansions.”<sup>4</sup> It was not until the 1920s and 1930s that the “Tudor Revival style was adapted to the middle-class suburban house and eventually became especially popular for the affordable small house.”<sup>5</sup> Featuring steeply pitched roofs, often with side-gable roofs, decorative half-timbering is common as are tall, narrow windows often grouped together, multi-pane lights or glazing, and massive brick chimneys.

Much like the Queen Anne style, this popular style is known as “historically imprecise” because very few characteristics of the style as represented in North America match that of the early 16<sup>th</sup>-century Tudor style found in England. Early versions of the Tudor Revival style were often architect designed masterpieces that did closely mimic Medieval English Tudor homes. Featuring Renaissance detailing of the Elizabethan and Jacobean eras, these early Tudor structures are sometimes referred to as the Jacobethan type. However, from 1900 to 1920, “less pretentious” Tudor style homes became common, although they often featured wood shingle cladding or stucco applied over lath. As masonry veneering techniques became more accomplished in the 1920s and 30s, Tudor style cottages became much more prolific, resulting in “endless variations in overall shape and roof form...[allowing] even the most modest examples to mimic closely the brick and stone exteriors seen on English prototypes.”<sup>6</sup>

Identifying features of the Tudor Revival style include a steeply pitched roof; multiple cross-gables often with a dominant front facing gable; tall vertical windows often grouped together; an asymmetrical façade; false half-timbering with stucco infill; brick or masonry veneer with decorative elements; multi-pane glazing; and arched entries and doorways.

The Tudor style also had numerous subtypes. A feature of the Sheehy-Kelleher House, brick veneer wall cladding “is the most common Tudor subtype.”<sup>7</sup> Although other subtypes include stone wall cladding, wooden wall cladding, the false thatched roof, and parapeted gables, the brick cladding subtype “became the preferred wall finish for even the most modest Tudor cottages.”<sup>8</sup> Often featured in conjunction with another contrasting wall material, such as stucco and decorative or false half-timbering in upper stories or

---

<sup>4</sup> Carley, Rachel. *The Visual Dictionary of American Domestic Architecture*. New York: Henry Holt and Company, 1994, p. 200.

<sup>5</sup> Ibid.

<sup>6</sup> McAlester and McAlester, 358.

<sup>7</sup> Ibid, 355.

<sup>8</sup> Ibid.

gables, the proliferation of brick wall cladding resulted in elaborate decorative patterns featured on Tudor Revival style homes.

Tudor Revival style features depicted on the Sheehy-Kelleher House include the home's side-gable orientation, prominent front facing gabled partial-width front porch, Roman arch openings in the porch, decorative brick detailing in the gable peaks, large brick chimney, and steeply pitched tiled roof.

***Summary***

The Sheehy-Kelleher House is well-preserved at the exterior and retains good to excellent exterior architectural integrity in original location, design, materials, workmanship, and association as a single-family residential house form built in 1934 along East Mission Avenue in the Logan Neighborhood of Spokane, Washington. Achieving historic and architectural significance from 1934 to 1967 in the context of "architecture" in Spokane, the Sheehy-Kelleher House is nominated for listing on the Spokane Register of Historic Places under Category C.

**BIBLIOGRAPHY**

Brooks-Miller, Scott. *Mission Avenue Historic District*. National Register of Historic Places Nomination Form, 1986.

Carley, Rachel. *The Visual Dictionary of American Domestic Architecture*. New York: Henry Holt and Company, 1994.

McAlester, Lee & Virginia. *A Field Guide to American Houses*. New York: Knopf Publishing, 1989.

Spokane City Building Permits. Spokane City Hall, Spokane, WA.

Spokane County Public Records. Spokane County Courthouse, Spokane, WA.



# The Kelleher Home

## Historical Significance

The house that currently stands at East 429 Mission Avenue, a one and a half story Tudor-style Bungalow, was built in 1934 by Otto Bloomquist and Son, a long-time carpenter. The style was common in the late 1920's in Spokane; it looks like several houses constructed by a builder named Pearce on West 20<sup>th</sup> Avenue on the South Hill. However, this house is the only one of this style and architectural design in the Heath and Sinto (Cataldo) additions (which are separated by Mission Avenue).



The building permit for this house was issued August 14, 1934 to John J. Sheehy. Mr. Sheehy and his wife owned the home until 1967, when it was sold to the current owners, Ray and Cathy Kelleher.

The information directly below tells the story of the current house. However, as you read further, you will see that the history of the property may be tracked as far back as 1882, when it was purchased by Sylvester Heath from the Northern Pacific Railway.

## Original specifications:

Building Permit number 43234 was issued August 14, 1934 to J.J. Sheehy—owner of the lot located at E 429 Mission. Mr. Sheehy's home address was listed as 730 E Boone Ave; he was chief clerk with the Union Pacific Railway Company.

The 1903 City Directory shows the builder, Otto Bloomquist and Son, living at 224 Huron; the 1905 directory showed him as residing at 1409 Main Ave; and the 1934 directory lists the carpenter's business at 1120 S Walnut St.

The house, a one and a half story Tudor-style Bungalow, has a foot print of 1,470 square feet. It has a side gable roof, with projecting gable additions on one side and an end-gable roof porch on the front. The house and its non-attached single-car garage are brick veneer.

The front porch and entry has five brick Roman arches and a darker, decorative brick diamond pattern design at each gable point. This style was common in the late 1920's in Spokane; it looks much like several houses constructed by a builder named Pearce on West 20<sup>th</sup> Avenue on the South Hill.

The five rooms on the Main floor consist of a large living room, dining room, kitchen, bathroom and two bedrooms. The flooring was oak, except for the kitchen which was red fir. The house was built with a finished and plastered stairway to the upper half-story (845 square feet) and an unfinished, full basement.

#### **Additions and changes:**

- October 28, 1936: Permit number 47945  
A brick veneer second garage was constructed and attached to the existing garage by builder R.C. Toepel.
- July 31, 1967  
Jane A. Sheehy—individually, and an executrix of the estate of John J. Sheehy, deceased—conveyed to Raymond L. and Catherine G. Kelleher—husband and wife—for the sum of \$19,000, the home and property (Lot 7 in Block 46 of Heath's Addition IV, Locates in Twp 25 Range Sect SW in Spokane County, Washington. Statutory Warranty Deed 309519C [Deed book 890, page 334]).
- December 7, 1967: Electrical Permit number C 9998, Power City Electric  
A 200 amp electrical service was installed, the home was rewired and power was extended to the half-story and garage.
- 1971:  
The house was re-plumbed and the half-story was finished by the owner. The half-story has two bedrooms, a bath, and five walk-in closets. To match the first floor, the walls were finished in plaster and the doors and moldings are identical.
- July 6, 1972: Permit number B 1946  
A wood fence with brick posts was constructed. The posts were made from recycled street bricks that were removed from the Gonzaga University area.
- 1985:  
The original painted kitchen cabinets were replaced with oak cabinets.
- December 1, 1993: Permit number B9305730:  
Installed gas service. Replaced original oil-fired furnace with gas burning unit.
- June 13, 2005: Permit number B0506646:  
Owner installed an egress window in the basement den (over the years, the owner installed lighting, a ceiling, walls, sheetrock and flooring to gradually finish the basement).
- March 29, 2006: Permit number B0603533:  
Owner installed an egress window in the basement family room.

The interior and exterior of the home have remained essentially the same as when the home was constructed in 1934. Except for the kitchen, the light fixtures are all period-correct.

**An Historical Overview of 429 E. Mission and its developer, Sylvester Heath**  
Otherwise known as: Lot 7, Block 46 of Health's IV Addition in Spokane TWP 25; Range 43, Section SW; Tax/Parcel Number 35083-4607

**Sylvester Heath** was born March 20, 1847, near Noblesville in Hamilton County, Indiana. He came west to Walla Walla in 1878. In 1879 he moved to Spokane Falls, Washington Territory. He first settled on a 360 acre farm, a region where Mica is now situated. Besides farming, he raised Morgan thoroughbreds. One of 15 benefactors, including J.N. Glover and A.M. Cannon, Heath pledged monies to Father Cataldo in October 1881 for construction of a college (Gonzaga).

Heath began his mercantile career in the merchandise store on Cannon and Warner, where the post office was located. After being appointed postmaster, he opened a stationery store in conjunction with the post office. His store, located at 101 W. Riverside Ave., was destroyed by the 1889 fire. He turned over his stationery business to John W. Graham.

On June 11, 1882 he married Ida E. Ellis. Ida Ellis was born in Brownsville, Oregon on June 4, 1863. She came to Spokane Falls in 1877. The Heaths commenced housekeeping in a small house on Riverside and Monroe. After the fire of 1889, they moved to a house on the corner of Mission and Dakota.

In 1882, Sylvester Heath purchased a half-section of land, bounded by Carlisle Street on the north; Mission Avenue on the south; Victoria (Division) Street on the west; and Perry Street on the east. Heath's south property line is adjacent to property purchased by Joseph M. Cataldo, a Jesuit priest. By inference, the property was purchased after February 24, 1882. Schoenburg's "Gonzaga University—Seventy-five Years 1887-1962," relates that on February 24, 1882, Northern Pacific had not received deed from the Government (Reference Township 25 N-Range 43). On April 8, 1882, Father Van Gorp paid Judge Lewis for the half-section.

- Heath's First Addition to Spokane Falls Territory was surveyed and certified by H.M. Maxwell in June 1883; and filed and recorded in the Book of Plats January 12, 1884. It was bordered by Sellwood Street (Lidgerwood) on the west; Dakota Street on the east; Carlisle on the north; and Indiana on the south.
- Heath's Second Addition – May 27, 1884: Indiana on the north; Mission on the south; Victoria (Division) on the west; and Sellwood Street (Lidgerwood) on the east.
- Heath's Third Addition – September 1, 1886. Carlisle on the north; Indiana on the south; Victoria (Division) on the west; and Sellwood Street (Lidgerwood) on the east.
- Heath's Fourth Addition was dedicated to Spokane Falls, Washington Territory on December 15, 1887 and recorded on January 9, 1888. Indiana on the north; Mission on the south; Sellwood Street (Lidgerwood) on the west; and Dakota on the east, excluding the plot from Pacific (Standard) to Dakota and Mission to Nora.

On this plat Sylvester Heath built his home in 1898; the address was 613 E. Mission Ave.

- Heath's Fifth Addition, August 25, 1889. Dakota on the west; Harrison (Perry) on the east; Carlisle on the north; Mission on the south.

On January 7, 1913, Mr. and Mrs. Sylvester Heath donated two lots on the corner of Mission and Standard, valued at \$7,000, to the city for a library. A contract was awarded to John T. Hutter with a bid of \$27,584 (*Spokesman Review*, July 2, 1913). The corner stone for the Heath's Library was laid November 15, 1913 by C.O. Conner, chair of the Library Board. Placed in the cornerstone was a copper box containing the deed from Mr. and Mrs. Heath (*Spokesman Review*, November 16, 1913).

On March 6, 1917, Mrs. Ida E. Heath died while in California.

On August 26, 1918 Sylvester Heath married Mrs. D.C. Newman (Mary Vye Hickey), widow of a pioneer physician. Mary Van Hickey was born in Quincy, Indiana in 1859 and was raised in Muncie, Indiana. She came to Spokane Falls in 1889 with her husband Dr. D.C. Newman.

Sylvester Heath died October 10, 1925. He was recognized as one of Spokane's pioneer capitalists.

After Sylvester Heath's death, Mary carried on the business affairs, maintaining a downtown office for many years. She died May 6, 1937.

#### **The lot at 429 E Mission Ave**

- First deed - March 10, 1894: Sylvester Heath and Ida A. Heath sold Lot 7 in Block 46, Heath's IV Addition, in Spokane TWP 25; Range Section SW; Tax/Parcel NO 35083-4607: E. 429 Mission, to Ingeborg Chilberg for \$800. (Deeds Book 58, Page 552)
- 1895: Water Permit: NO: 767 - Wm. Brown & Associates
- Permit records: First Floor - 4; Second Floor - 4; Baths - 1; Stable
- 1895 to October 26, 1897: Ingeborg Chilberg and her husband Whilberg Chilberg, a carver for Washington Mill Co., lived at 429 E. Mission
- October 26, 1897: Ingeborg Chilberg and Whilberg Chilberg sold the property to George T. Brown and Alberta Brown, husband and wife. George Brown was a bookkeeper at Spokane Drug Company. (Warranty Deed 18156) [Deeds Book 84, Page 525]
- January 27, 1899: George T. Brown and Alberta Brown sold the property to James C. Towhy, for \$4,500. (Warranty Deed 28836) [Deed Book 97, Page 12] James C. Towhy came to Spokane Falls from Minnesota with his brothers Denis D. and John W. The Towhy Brothers were railroad contractors.

- November 30, 1907; Electrical Permit NO: 183; Contractor – Spokane Electric
- 1909 - Sewer Permit: NO: 3511 - Peterson
- May 8, 1909: Edmund Paul Twohy, executor of the deceased James C. Twohy sold the property to Charles E. Watson, for \$2,150. (Deed 2.64545) [Deed Book 244, Page 546]
- December 19, 1910: Charles E. Watson and Lilly N. Watson sold the property to Henry C. Lewis for \$10,000. (Warranty Deed 30-7213) [Deeds Book 354, Page 186]
- January 21, 1911; Water Meter – Permit NO: 2234 - H.L. Lewis
- December 14, 1914: Henry C. Lewis and Ada L. Lewis, husband and wife, were in default and the property went into foreclosure. John E. Koppe and Carrie Koppe, husband and wife, purchased the property from De Tweede Northwestern and Pacific Hypetheek Bank, a corporation formed under the laws of the Kingdom of the Netherlands, for \$3,137.40. (Warranty Deed 439111) [Deed Book 243, Page 266]
- May 15, 1922: Jennie E. Sherman, wife of Gardner E. Sherman, as her sole, separate and individual property, conveyed the property to Emma F. Stone, wife of Wesley C. Stone, for \$1. (Quit Claim Deed 694315) [Deed Book 398, Page 13]
- June 24, 1924 (Quit Claim Deed 760297): Emma F. Stone, wife of Wesley C. Stone, to Jennie E. Sherman, wife of Gardner E. Sherman, for \$1. Gardner E. Sherman was a salesman for T&G (Tull & Gibbs, a Spokane prestigious furniture store). [Deed Record 394, Page 558]
- The Sanborn Insurance Maps from 1910 to 1926 show a two-story wooden structure, single-family house with a wraparound porch, a building on the northeast corner of the lot and a small building on the northwest corner of the lot.
- February 19, 1934: Emma F. Stone and Wesley C. Stone, husband and wife, conveyed to De Tweede Northwestern and Pacific Hypotheek Bank all interest of the property, for \$1. (Quit Claim Deed 159755A Filed Feb. 23, 1934) [Deed Book 459, Page 284]
- February 16, 1934: De Tweed Northwestern and Pacific Hypotheek Bank transferred the property to John J. Sheehy and Jane A. Sheehy, his wife, for the sum of \$10,000 (Deed 159935A filed Feb. 26, 1934) [Deed Book 459, Page 299]. Sheehy was chief clerk with the Union Pacific Railway Company.

Apparantly, De Tween Northwestern and Pacific Hypotheek Bank, located at 120 N Wall Street, held the mortgage on the property from 1914 to 1934. There are no deeds of record showing the transfer of property from John E. Koppe and his wife, Carrie to Jennie H. Sherman.

**Current owners: The Kelleher family**

Raymond L. (Ray) Kelleher came to Spokane in August 1954 with a Marine Corps detachment assigned to the NAS, Spokane at Geiger Field. He married Catherine (Cathy) Baldus August 18, 1956.

Ray graduated from Gonzaga University and taught grade school for one year. He returned to Gonzaga and continued classes in Chemistry. During this time, he worked weekend nights as an officer on the City of Cheney Police department.

He was asked to join two GU professors in research and development of air pollution control and monitoring equipment. He then formed a company to manufacture mobile monitoring labs, including air, water and noise pollution, and provided professional air pollution monitoring and consulting services.

Kelleher built and operated Spokane's first Vehicle Emission Testing Station, located at 819 N. Hamilton Street, in 1986 and built and operated a facility to recycle electrical transformers and equipment for utility companies. After selling that business and retiring, he went back to teaching—substituting in math and science for Spokane School District #81. He also serves on the Advisory Board for the Spokane County Air Pollution Control Authority (SCAPCA).

Cathy was born in Genesee, Idaho. She graduated from Holy Names College with a degree in Education and later received her Masters in Education from Gonzaga University. She taught in District 81 for 40 years.

Ray and Cathy have four children. All attended St. Aloysius Grade School and Gonzaga Preparatory High School.

- Patrick (born February 14, 1958) received a degree in Mechanical Engineering at Gonzaga University and later his Masters in Aeronautical Engineering from the University of Tennessee while serving as a Marine Corps test pilot at NAS, Patuxent River, Maryland. He retired after 20 years in the Marines and currently works for a defense contractor.
- Michael (September 1, 1961) received a BA in Radio-Television Production and Management from Eastern Washington University. He worked with his father for several years in the family's businesses; as well as part-time in radio and television. He currently works in Public Relations at Sacred Heart Medical Center.
- Thomas (April 15, 1966) received a BA in Marketing at Washington State University. He did marketing work for software firms in Seattle before traveling to London, England, where he worked for a large marketing firm. He currently is a senior manager for a marketing and branding firm in San Francisco, California.
- Anne (May 26, 1970) received her Bachelors and Masters in Criminal Justice from Washington State University. She taught Criminal Justice for the University of Idaho (Moscow, ID), and is a commissioned law enforcement officer.







Alley Lot 7  
50'

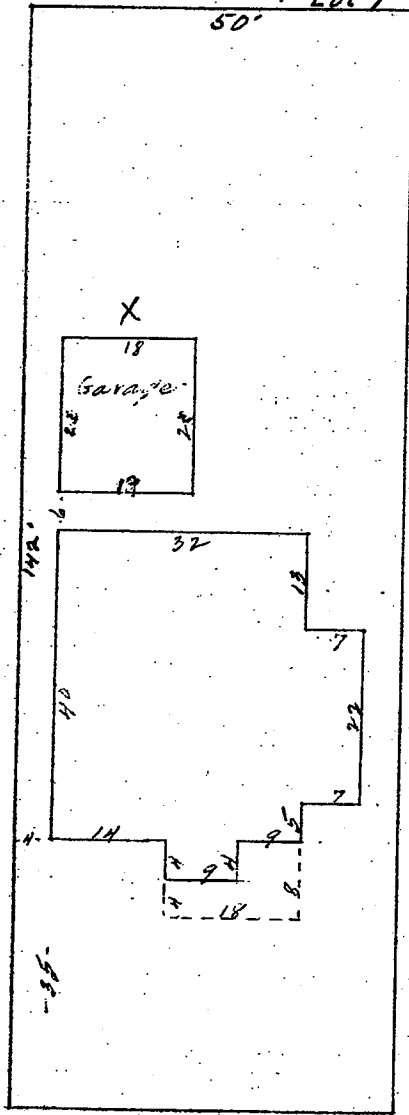

E. 429 Mission Ave.