

SPOK. THE REGISTER OF HISTORIC PLACES

Nomination Form

City/County Historic Landmarks Commission
Sixth Floor - City Hall
Spokane, Washington 99201-3333

Type all entries--complete applicable sections

1. Name Central Schoolhouse District #49

historic Central Schoolhouse District #49

and/or common Same

2. Location

street & number No Street Address, Located at the Northwest Corner of
city/town Nine Mile Falls vicinity of Ritchey and Four Mound Rds.
state WA county Spokane

3. Classification

| Category | Ownership | Status | Present Use | |
|---|--|--|--|--|
| <input type="checkbox"/> district | <input checked="" type="checkbox"/> public | <input type="checkbox"/> occupied | <input type="checkbox"/> agriculture | <input type="checkbox"/> museum |
| <input type="checkbox"/> building(s) | <input type="checkbox"/> private | <input checked="" type="checkbox"/> unoccupied | <input type="checkbox"/> commercial | <input type="checkbox"/> park |
| <input checked="" type="checkbox"/> structure | <input type="checkbox"/> both | <input type="checkbox"/> work in progress | <input type="checkbox"/> educational | <input type="checkbox"/> private residence |
| <input type="checkbox"/> site | | | <input type="checkbox"/> entertainment | <input type="checkbox"/> religious |
| <input type="checkbox"/> object | Public Acquisition | Accessible | <input type="checkbox"/> government | <input type="checkbox"/> scientific |
| | <input type="checkbox"/> in process | <input checked="" type="checkbox"/> yes:restricted | <input type="checkbox"/> industrial | <input type="checkbox"/> transportation |
| | <input type="checkbox"/> being considered | <input type="checkbox"/> yes:unrestricted | <input type="checkbox"/> military | <input checked="" type="checkbox"/> other: |
| | | <input type="checkbox"/> no | | |

4. Owner of Property

name West Greenwood Cemetery District #2

street & number W. 21510 Four Mound Rd. (Mailing Address)

city,town Nine Mile Falls vicinity of state WA 99026

5. Location of Legal Description

courthouse,registry of deeds,etc Spokane County Courthouse

street & number Spokane Courthouse

city,town Spokane state WA

6. Representation in Existing Surveys

title NONE

date federal state county local

depository for survey records

city,town state

7. Description

| Condition | Check one | Check one |
|--|---------------------------------------|---|
| <input type="checkbox"/> excellent | <input type="checkbox"/> deteriorated | <input checked="" type="checkbox"/> unaltered |
| <input checked="" type="checkbox"/> good | <input type="checkbox"/> ruins | <input checked="" type="checkbox"/> original site |
| <input type="checkbox"/> fair | <input type="checkbox"/> unexposed | <input type="checkbox"/> moved date _____ |

Describe the present and original (if known) physical appearance

Description

Constructed in 1900, the simple schoolhouse erected for Central School District No. 49 has retained its integrity of appearance over the years. The area surrounding the school was covered with timber at the time of construction, and nearby sawmills produced the lumber for the building.

Designed as a one-story, single-room facility, the schoolhouse measures 24 feet by 36 feet. An 8-foot wide porch shelters the two entrances in the south gable end. According to school records, the original porch, dating from 1902, was constructed of wood. At a meeting of the School Board on June 24, 1916, the Board voted to replace the wooden porch floor with cement, and to pour a 4-foot wide sidewalk extending to the gate at Four Mound Road. Situated at the end of the walk was to be a gate with an arch above. Both the sidewalk and the gate have since been removed. In 1937 the cement porch was replaced with that presently in use.

Situated on a stone foundation, the schoolhouse is constructed of wood, and retains its original wood butt-edged weatherboarding. Simple cornerboards trim the edges of the building, while modest fascia boards line the end gables. The existing cedar shingle roof dates from 1935; it matched the original roof.

Three windows with two-over-two sash are found along the east and west elevations. At the south end, both entries had transoms above paneled doors; the westernmost door has four vertical panels, while its companion is comprised of five horizontal panels. A small triangular sign announcing "Central School District No. 49" graces the upper gable; the School Board voted to install the sign at their March 28, 1904 meeting. A flag pole stands at the peak of the gable on this main facade. Only a small brick chimney rising from the gabled roofline graces the north end of the building.

Spokane Register of Historic Places Nomination Form

Continuation sheet

Item number

7

Page 2

Although slightly altered over the years, the interior of the Central Schoolhouse also maintains a high degree of its original integrity. Constructed without partitions as an open rectangular space, the interior was first finished with ceiling lumber on the walls and ceiling. Although a wood stove provided some warmth during the cold winter months, wallboard was later added to the ceiling and down the walls to provide additional insulation. Approximately 3 1/2 feet of wooden wainscoting remains visible along the perimeter of the space. In addition, blackboards line the west, north, and east walls.

The floor was also covered at a later date with hardwood flooring to provide additional warmth. At the north end of the building, the floor level changes slightly, rising approximately 6" above the main floor to create the effect of a stage.

Of the early furnishings, which included desks and seats for the students, only a piano, six single-globe light fixtures, and a built-in cupboard/bookshelf in the northeast corner remain. The piano was purchased on October 3, 1932. Although the accompanying claw-foot piano stool was stolen several years ago, the piano itself has long been linked to Central School.

Initially, the school building had neither electricity or water. On November 30, 1920, the Board bought a double gas light for \$24.00; the hangar for it is still in the wall. This supplemented the kerosene lamps used to provide light. On September 1, 1945, a \$5 membership fee was paid to the Rural Electrification Association. The schoolhouse was then wired for electricity, and the fixtures currently in existence were hung. The first bill for a month's electricity came on October 27, 1945---the amount due was \$5.76.

In order to secure water, two of the older children would hike to a nearby spring. Each child held the end of a pole, with the water bucket hanging in between. In 1924, a well was finally drilled for the school. The total cost was \$208.21, and visitors can still use a hand pump to draw water from the well.

Only one outbuilding remains in the schoolyard--a small toilet of wood construction situated behind the school. Originally, there were two toilets on the property; a wood shed measuring 12 feet by 8 feet was also located northwest of the school.

8. Significance

| Period | Areas of Significance-Check and justify below | | |
|---|---|---|--|
| <input type="checkbox"/> prehistoric | <input type="checkbox"/> archeology-prehistoric | <input type="checkbox"/> economics | <input type="checkbox"/> military |
| <input type="checkbox"/> 1400-1499 | <input type="checkbox"/> archeology-historic | <input checked="" type="checkbox"/> education | <input type="checkbox"/> music |
| <input type="checkbox"/> 1500-1599 | <input type="checkbox"/> agriculture | <input type="checkbox"/> engineering | <input type="checkbox"/> philosophy |
| <input type="checkbox"/> 1600-1699 | <input type="checkbox"/> architecture | <input type="checkbox"/> exploration/settlement | <input type="checkbox"/> politics/government |
| <input type="checkbox"/> 1700-1799 | <input type="checkbox"/> art | <input type="checkbox"/> industry | <input type="checkbox"/> religion |
| <input type="checkbox"/> 1800-1899 | <input type="checkbox"/> commerce | <input type="checkbox"/> invention | <input type="checkbox"/> science |
| <input checked="" type="checkbox"/> 1900- | <input type="checkbox"/> communications | <input type="checkbox"/> landscape architecture | <input type="checkbox"/> sculpture |
| | <input type="checkbox"/> community planning | <input type="checkbox"/> law | <input type="checkbox"/> social/humanitarian |
| | <input type="checkbox"/> conservation | <input type="checkbox"/> literature | <input type="checkbox"/> theater |
| | | | <input type="checkbox"/> transportation |
| | | | <input type="checkbox"/> other(specify) |

Specific dates

Builder/Architect

Statement of Significance (In one paragraph)

Significance

A focal point for both educational and social activities since the turn of the century, the schoolhouse constructed in 1900 for Central School District No. 49 is today one of the few one-room school buildings remaining in the northwest portion of Spokane County. At the time of its completion, there were 18 one-room schools in the immediate vicinity; with the exception of Central School, all have been demolished or moved to other locations to use for other purposes. In constant use as a school from 1900 until 1956, the schoolhouse looks much the same as it did when it first opened on September 3, 1900.

The original Central School, sometimes known as Baldwin School, was situated east of the present building across Ritchey Road. At its June 1899 meeting, the School Board decided to poll its voters concerning the location of a new school; seventeen votes were cast in favor of the current site.

With funding provided by bonds totaling \$600.00, School District No. 49 commenced work on the new school. The two acres of land on which the school is situated were purchased for \$5.00 from Ludwig and Theobald Jurgens. The Jurgens Brothers also supplied the lumber for the building at a cost of \$174.43; R.C. Tapley and J.M. Starkey built the schoolhouse. Records for the School District indicate the following expenditures:

Tapley worked 32 days and was paid \$80.00 on July 31, 1900.

Starkey worked 32 1/2 days at \$2.75 per day; paid \$89.35 on July 31, 1900.

Lemon Lynch was paid \$5.00 to clear the school grounds.

Spokane Register of Historic Places Nomination Form

Continuation sheet

Item number 8

Page 2

J.N. Frazier was paid \$62.00 to construct a flue and a rock foundation.

The first furnace was purchased at Reardan and hauled to school for \$1.00. A new furnace purchased June 1925 was \$195.00.

Fifty-two children were enrolled for the first year (1900 - 1901) at Central School. Although the school served grades one through eight, only one teacher was available to provide instruction. Miss Lillian Scott, the first teacher there, received \$40.00 per month for her efforts. Not surprisingly, the turnover rate for teachers was quite high. Between 1900 and 1956, the Clerk's Record Books indicate that 46 teachers served the School District at this location.

With class sizes dwindling dramatically, the decision was made to consolidate Central School with Reardan in 1956. During the last year of classes at Central, there were only seven students, with three graduating from the eighth grade.

In 1958 the Coulee Township acquired the schoolhouse from Rearden Consolidated Schools District 219/412, using it as a meeting site until the demise of the township system. The township supervisors then deeded the property to West Greenwood Cemetery District #2 in 1973. Since that time, it has provided a site for meetings of the Cemetery District, the Home Economics Club, and various social events in the community.

Today, Central Schoolhouse remains a visible symbol of the important role it played in the educational and social lives of local residents. Not only did this simple one-room structure provide the setting for lessons in grades one through eight, but it was also a focal point for community activity. Box socials were held here to raise money for school projects; 4H meetings, square dances, club meetings, parties and other special events all took place here as well. Under the auspices of the Cemetery District, the Central School remains available for community use today.

9. Major Bibliographical References

The record book from the school from 1899 until 1930, and the old record books kept by the teachers. Old School souvenirs with names and dates of events. These also provided names of teachers throughout the years.

10. Geographical Data

Acreege of nomlnated property Two Acres

Verbal boundary description and justification

SE corner of SE $\frac{1}{4}$ of Sec. 35 Township 27 Range 40 from the SE corner running West 20 rods, then North 16 rods, then East 20 rods and then South 16 rods.

llst all states and countles for properties overlapping state or county boundaries

state

county

state

county

11. Form Prepared By

name/title Alice Lynch * Secretary

organization West Greenwood Cemetery

date 6/4/91

street & number W. 21510 Four Mound Road

telephone

city/town Nine Mile Falls

state WA 99026

12. Signature of Owner(s)

Bliss Lynch - Secretary

For Office Use Only:

Date Received: 7-1-91

Date Heard: 7-17-91

Commission Decision: Approved

Council/Board Action: _____

Date: _____

Attest: _____
City Clerk

Approved as to Form: _____

Ass't City Attorney

We hereby certify that this property has been listed on the Spokane Register of Historic Places:

MAYOR, City of Spokane or CHAIR, Spokane County Commissioners

[Signature]

CHAIR, Spokane City/County Historic Landmarks Commission

Katherine W. Darrett

City/County Historic Preservation Officer

585951B

Quit Claim Deed
BOOK 744 PAGE 504
Rec'd
Copied
Indexed
Recorded
Compared
Filed

FILED OR RECORDED
VOL. 44 OF DEEDS
PAGE 504 REQUEST OF
Vernon L Carstens
1958 DEC 17 AM 10 52
FRANK J. GLOVER, AUDITOR
SPOKANE COUNTY, WASH.
MAIL TO
Reardan, Wa

1.25

MAIL TO

—This deed is statutory form for use in State of Washington only—

585951B
QUIT CLAIM DEED
(After Acquired Title)

The Grantor Reardan Consolidated Schools, District 210/412

of Reardan, County of ~~Spokane~~ Lincoln, State of Washington
for and in consideration of \$1.00 and other valuable consideration Dollars
in hand paid, convey and quit claim to Coulee Township
whose address is Spokane County, Washington
all interest now owned or hereafter acquired in the following described real estate, situated in the County of
Spokane, State of Washington:

Part of the Southeast Quarter (SE+) of the Southeast
Quarter (SE $\frac{1}{4}$) of Section Thirty-five (35) Township
Twenty-seven (27) North, Range Forty (40) E.W.M. more
particularly described as follows:

Subsequent to

Beginning at the Southeast corner of the Southeast
Quarter of said Section 35, and running thence north
thirty (30) feet; thence west fifteen (15) feet to
true point of beginning; thence west along the Spokane
& Crescent road twenty (20) rods; thence north sixteen
(16) rods; thence east twenty (20) rods; thence south
sixteen (16) rods; Thence east twenty (20) rods; thence
south sixteen (16) rods to the place of beginning.

Dated this _____ day of _____, 1958

1% R. E. Excise Tax Exempt

Date Dec 17 1958

210/412

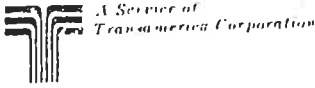

Filed for Record at Request of 7308030290

FILED OR RECORDED
REQUEST OF Derr & Derr

AUG 3 4 00 PM '73

VERNON OHLAND, AUDITOR
SPOKANE COUNTY, WASH.
DEPUTY *D. Gray*

2.00

Req W 921 Sprague

*Call
Wes*

Name.....
Address.....
City and State.....

Quit Claim Deed

Form 468-1-Rev

THE GRANTOR, COULEE TOWNSHIP, a Municipal Corporation,
for and in consideration of no dollars and to clear title in Grantee
conveys and quit claims to WEST GREENWOOD CEMETERY DISTRICT,
the following described real estate, situated in the County of Spokane, State of Washington,
together with all after acquired title of the grantor(s) therein:

Part of the Southeast 1/4 of the Southeast 1/4, beginning 30 feet
North and 15 feet West of the Southeast corner, then West 20 rods,
then North 16 rods, then East 20 rods, then South 16 rods to the
point of beginning, Section 35, Township 27 North, Range 40 E.W.M.,
Spokane County, Washington (Parcel No. 35704-9006),

And the West 445 feet of the East 955.68 feet of the South 213 feet
of the Southeast 1/4 of the Northwest 1/4, Section 22, Township 26
North, Range 40 E.W.M., Spokane County, Washington (Parcel No.
22602-9004).

1% Excise Tax on Real Estate
Sale, Amt. Ad \$ *None*
Date *7/30/73* No. *87145*
MERTON L. HOWARD, Co. Treas.
M. Roth

Dated this *17th* day of *July*, 1967.

By: *Harold Lucht*
Harold Lucht
Vernie Landt
Vernie Landt
George Lynch
George Lynch
Supervisors

STATE OF WASHINGTON }
County of Spokane }

On this day personally appeared before me Harold Lucht, Vernie Landt & George Lynch,
to me known to be the individuals described in and who executed the within and foregoing instrument, and
acknowledged that they signed the same as their free and voluntary act and deed, for the
uses and purposes therein mentioned.

GIVEN under my hand and official seal this *17* day of *July*, 1967.

James H. ...
Notary Public in and for the State of Washington,
residing at *677 ...*
James H. ...

NSHIP 27 N., RANGE 40 E.W.M.

STEVENS & SPOKANE COUNTIES, WASH.

111 50. TENTH ST., TACOMA, WASH.
1020 THIRD AVE., SEATTLE, WASH.
514 S.W.OAK ST., PORTLAND, ORE.

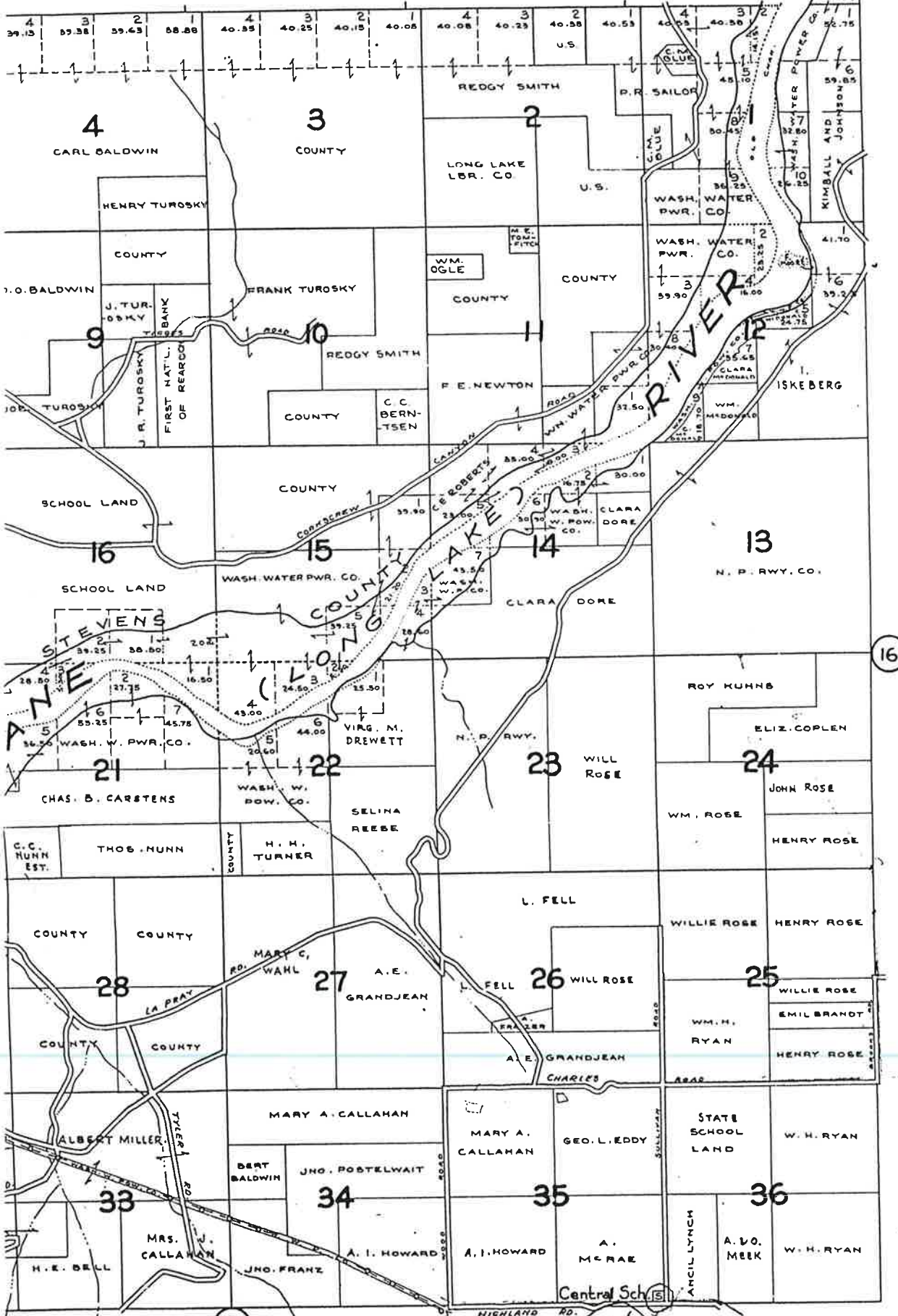

-LEGEND-

- PAVED ROADS
- MARKET ROADS
- OTHER ROADS
- TRAILS
- RAILROADS
- ELE. RWYS.
- SCHOOLS

2-110 K.V. LINES
1-60 "

